

## Optimum Value Assignment Sheet

NAMES:

PERIOD:

DATE:

Individually~~With a partner~~, students will be researching optimum value engineering on the internet, and then design~~building~~ an example of one OVE technique. Search the internet using terms like “optimum value engineering” and “advanced wall framing.” Read about how builders are reducing material and labor costs in framing, while still ensuring a rigid structure. Select one of the techniques that you found, and create a real-life model of it. ~~Your instructor will give you instructions on what scale and materials to use in building your model. Use the same scale we have already used – 1/2” = 1’.~~

Afterwards, research LEED, what it is, and how the re-design meets LEED requirements. What other requirements does LEED have for constructing buildings?

Upon completion of your drawing model, write a brief description that explains how

your design used OVE principles. Be sure to also explain how these principles

satisfy the LEED requirements for materials use and redirection.

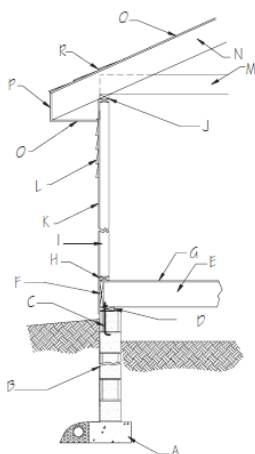

NOTES:

Formatted: Font: 8 pt, Font color: Blue, Expanded by 1 pt

--	--